



Founded in 1946

Project: \_\_\_\_\_

Items: \_\_\_\_\_

Quantity: \_\_\_\_\_

Approval: \_\_\_\_\_

Date: \_\_\_\_\_

# Film Wrapper

Winholt's Film Wrapper keeps produce fresh and maintains a sanitary kitchen. Make wrapping food efficient and easy with this product!

### Features:

- Aluminum and stainless steel construction
- Temperature controlled Teflon covered hot plate mounting axle system
- Cut off rod temp: 265° - 310°
- Adjustable heat options
- Cutoff rod has a built in thermostat to cycle energy, maintaining temperature when in use.
- Accommodates rolls of film up to 18" and 8" diameter.
- Core adapter holds film rolls with a 3" diameter core.
- Electrical loop rated @ 8 AMPS, 115 volts; overall 750 watts.
- ETL Listed

### Benefits:

- 100% pre-tested
- Sanitary and easily maintained
- Hot plate prevents sticking and seals film to ensure food stays fresh and protected.
- Low - high temperature option can be adjusted to maintain heat when being used throughout the day. Temperature can be turned down when not in use to save energy and prevent accidental burns.
- Complete line of ETL listed replacement parts. Our parts are fully compatible with other popular brands!
- State-of-the-art components ensure reliability and long life functionality.

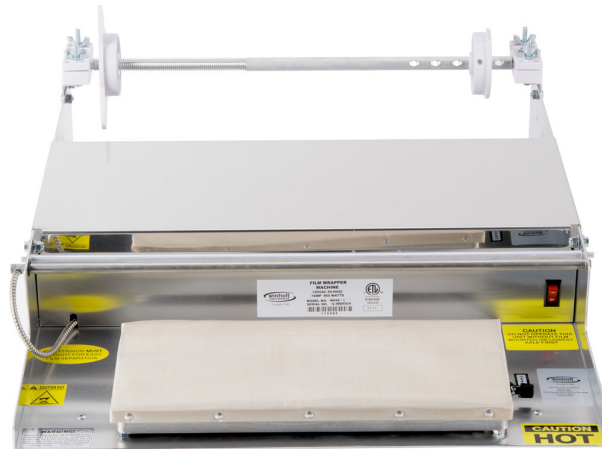

WHSS-1



Scan to watch our OPERATIONAL VIDEO



Scan to watch our ASSEMBLY VIDEO





Founded in 1946

# Film Wrapper

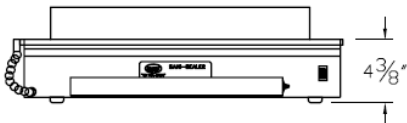
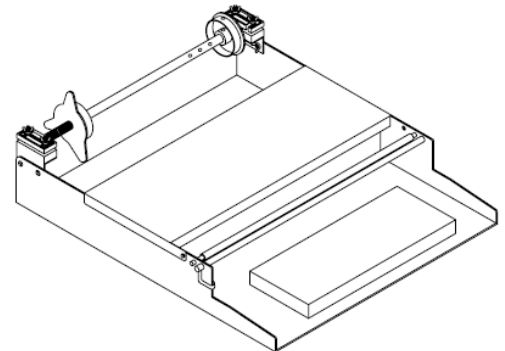
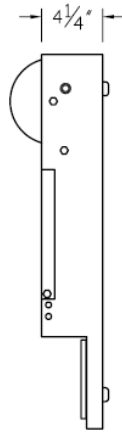
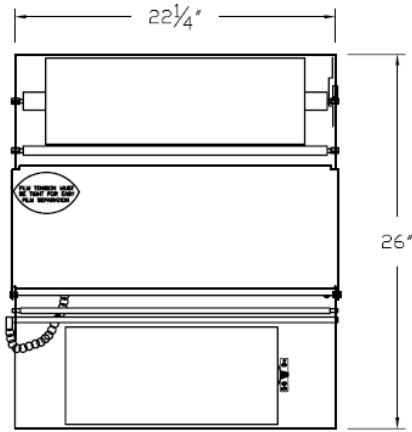

Model Number	Order#	# of Rolls	Hot Plate Dimensions (in)	Overall Dimensions						Approx. Ship Wt	
				Width		Length		Height		(lb)	(kg)
				(in)	(mm)	(in)	(mm)	(in)	(mm)		
WHSS-1	112985	1	6 x 15	22.25	565	26	660	5	127	18	8



In line with our policy to continually improve our products, Winholt reserves the right to change materials and specifications without notice.